

ST. IGNATIUS

AIRPORT LAYOUT PLAN

LAKE COUNTY, MONTANA

JULY 13, 2013

PROJECT LOCATION ST. IGNATIUS, MT.

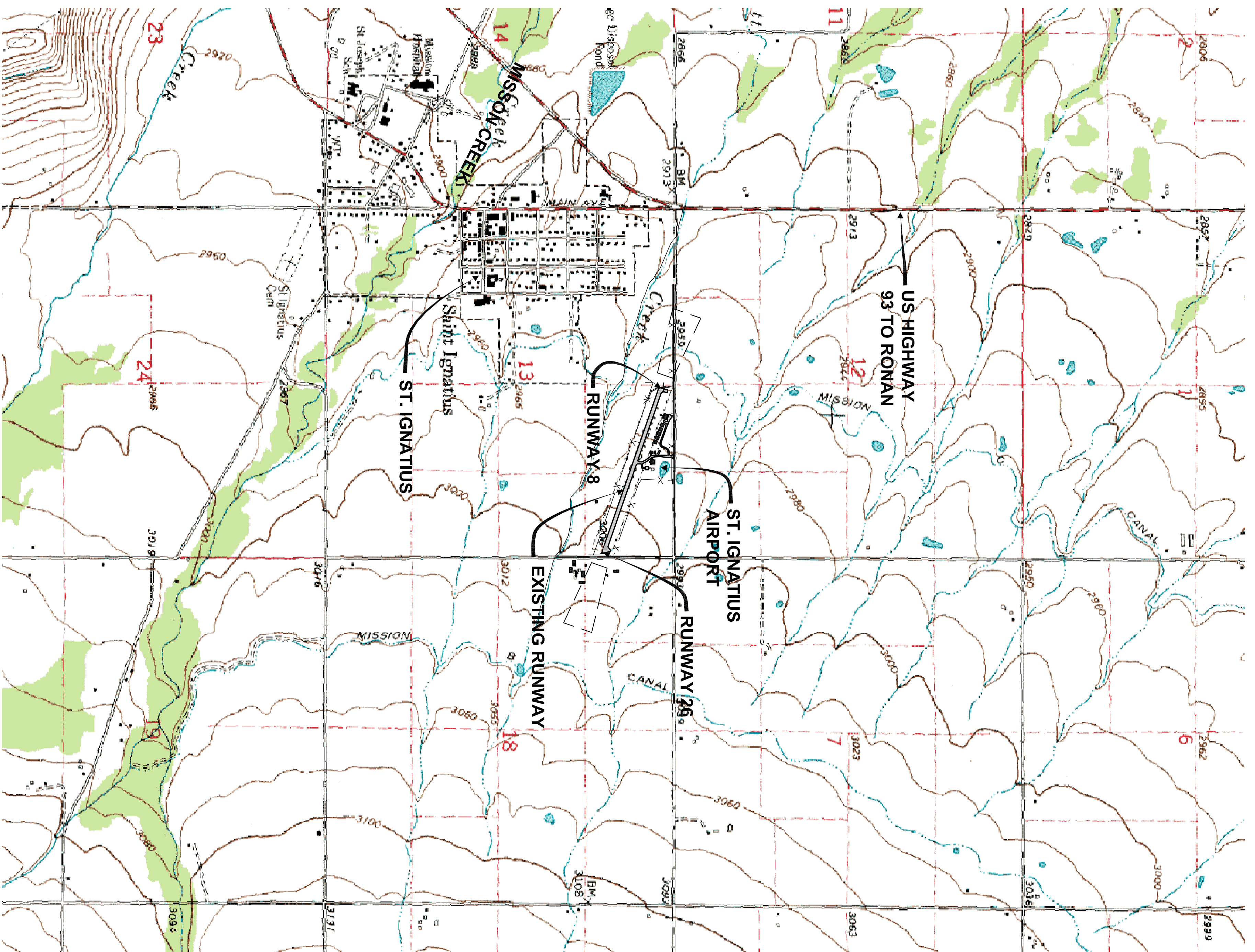
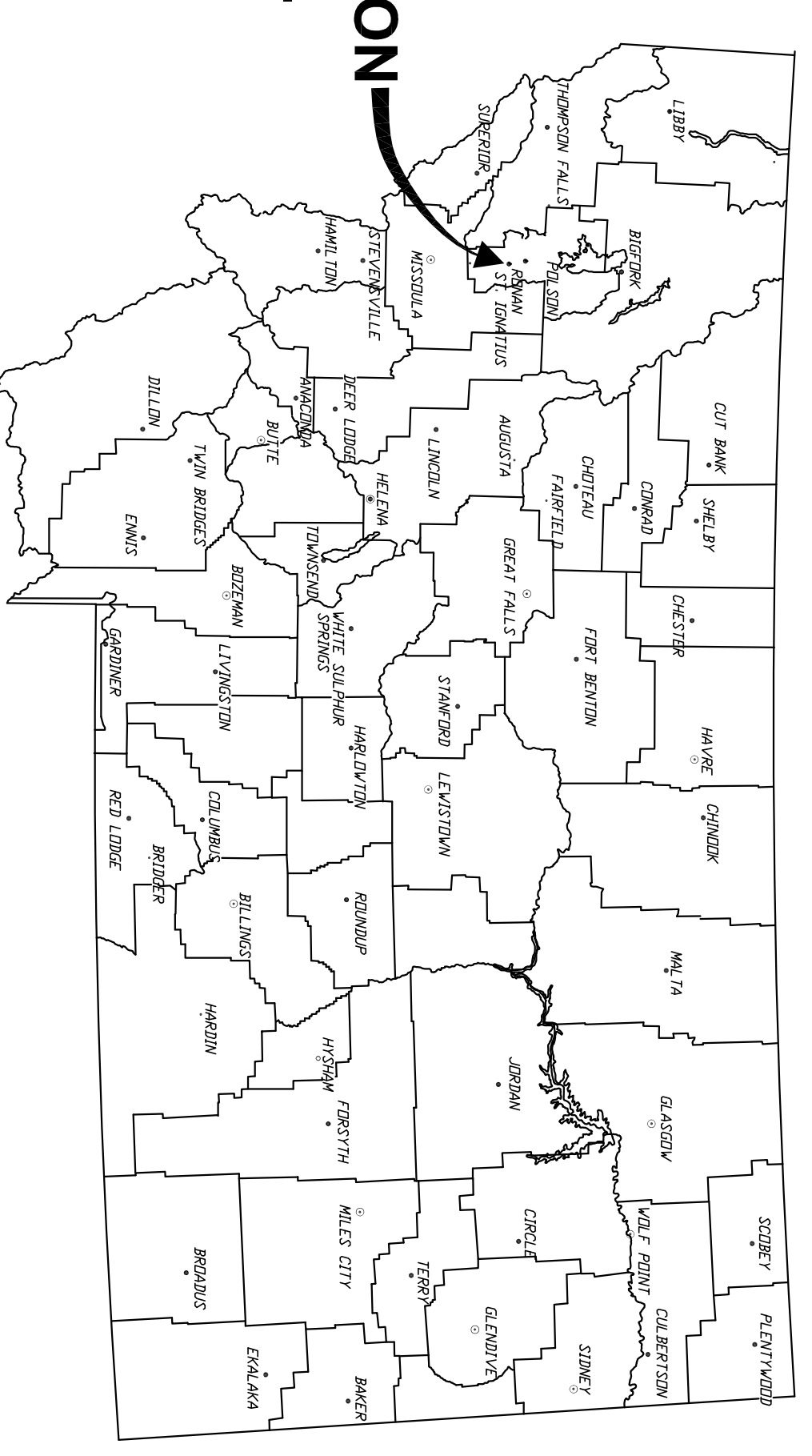

VICINITY MAP

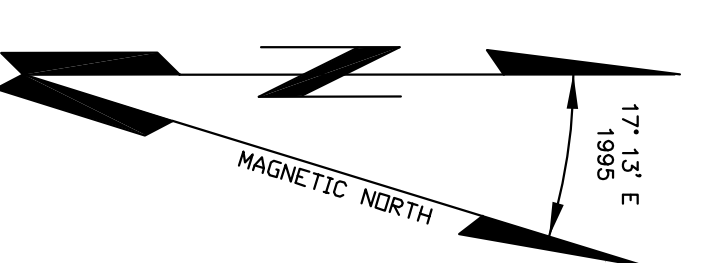

SCALE: 1"=1000 FEET (FULL SIZE)
 0 500 1000 1500 2000
 FEET
 TOWNSHIP 18N, RANGE 20 W. P.M.M.

SHEET INDEX	SHEET NO.
COVER SHEET	1
AIRPORT LAYOUT PLAN	2
AIRPORT AIRSPACE DRAWING	3
INNER PORTION OF THE APPROACH SURFACES (RUNWAY 8-26)	4
AIRPORT TERMINAL PLAN	5
AIRPORT AFFECTED AREA PLAN	6

NON-STANDARD CONDITIONS
NONE

AIRPORT LAYOUT PLAN APPROVED

DATE: _____
BY: RICK NEWMAN, CHAIRMAN
LAKE COUNTY JOINT AIRPORT BOARD

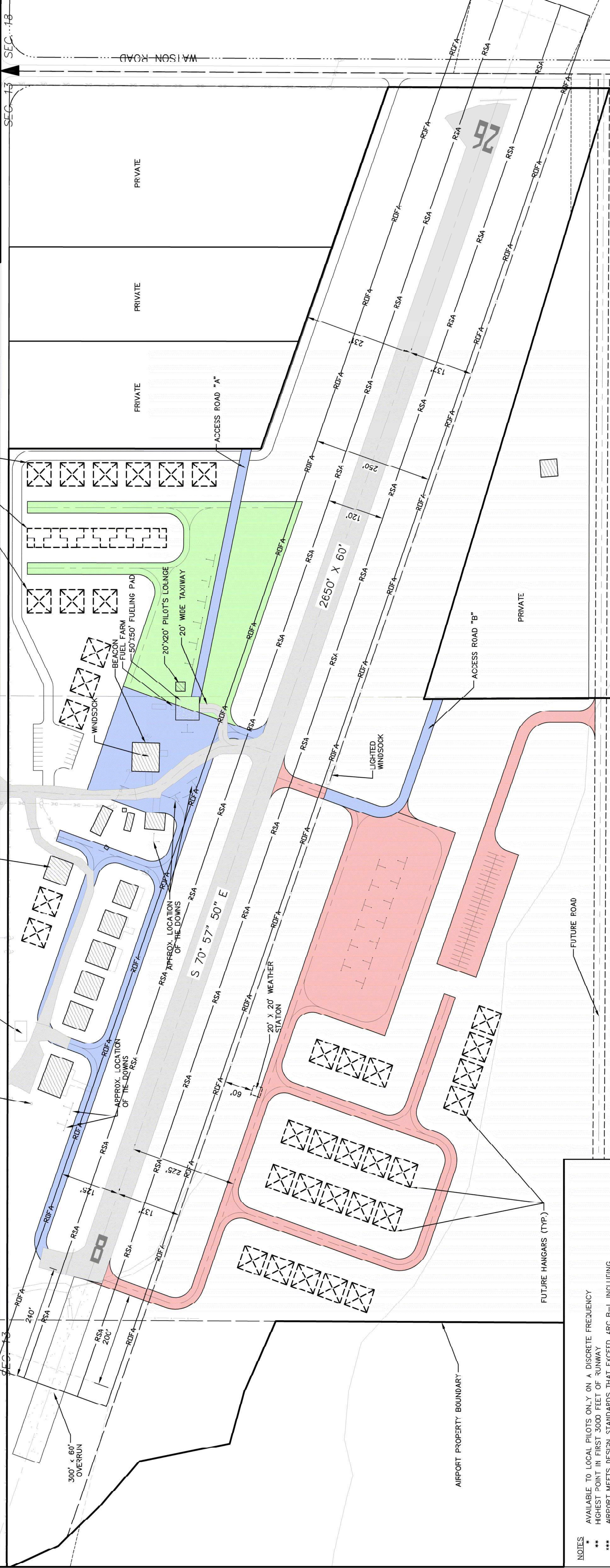

ITEM	8/26 EXISTING	8/26 FUTURE
RUNWAY DIMENSIONS (Length x Width)	2650' x 60'	2650' x 60'
EFFECTIVE GRADIENT %	1.51	1.51
TRUE RUNWAY BEARING	S 70° 57' 50" E	S 70° 57' 50" E
PAYEMENT STRENGTH (lbs) - SINGLE WHEELGEAR(S)	12,500 (S)	12,500 (S)
APPROACH SURFACE *	20' / 20.1	20' / 20.1
RUNWAY LIGHTING	NONE	SAME
TAXIWAY LIGHTING	NONE	SAME
LANDING MARKING	VISUAL B / VISUAL 26	REFLECTORS
APPROACH AIDS	NONE	BITUMINOUS
% WIND COVERAGE - ALL WEATHER (12.5 knots)	N/A	N/A
RUNWAY SAFETY AREA (Length x Width)	3130' x 120'	3130' x 120'
OBSTACLE FREE AREA (Length x Width)	3130' x 250'	3130' x 250'
APPROACH FREE ZONE (Length x Width)	3130' x 250'	3130' x 250'
APPROACH MINIMUMS	VISUAL	VISUAL
RUNWAY END ELEVATIONS ***	2972.50 / 3012.20	2972.50 / 3012.20
TOUCH-DOWN ZONE ELEVATIONS **	3012.20 / 3012.20	3012.20 / 3012.20
CRITICAL AIRCRAFT DATA ***		
A. RUNWAY LENGTH	2650'	2650'
B. RUNWAY PAVEMENT STRENGTH (lbs.)	12,500 (S)	12,500 (S)
C. WINGSPAN	GROUP 1	GROUP 1
D. APPROACH SPEED	CATEGORY B (SAE)	CATEGORY B (SAE)
E. TAIL HEIGHT	18'	18'

ITEM	EXISTING	FUTURE
AIRPORT ELEVATION (M.S.L.)	3072.20'	3072.20' *
ARP LATITUDE (NAD 83)	XXX	XXX
ARP LONGITUDE (NAD 83)	XXX	XXX
END RUNWAY 8 - LATITUDE	XXX	XXX
END RUNWAY 8 - LONGITUDE	XXX	XXX
END RUNWAY 26 - LATITUDE	XXX	XXX
END RUNWAY 26 - LONGITUDE	XXX	XXX
MEAN MAX. TEMP. - HOTTEST MONTH	83° F	SAME
WIND INDICATION	WIND CONE (ONE)	SAME
FUEL FACILITY	100LL	SAME
TERMINAL NAVIGATIONAL AIDS	WIND SOCK, BEACON, SEC. OR.	SAME
OBSTRUCTIONS	B-1 ***	B-1 ***
AIRPORT REFERENCE CODE (SEE NOTE)	B-1 ***	B-1 ***
NIPIAS ROLE	GENERAL AVIATION	SAME

NOTES

- * AVAILABLE TO LOCAL PILOTS ONLY ON A DISCRETE FREQUENCY
- ** HIGHEST POINT IN FIRST 3000 FEET OF RUNWAY
- *** AIRPORT MEETS DESIGN STANDARDS THAT EXCEED ARC B-I, INCLUDING RUNWAY/TAXIWAY SEPARATION, ROFA, TOFA, OFZ, AND RSA
- **** APPROXIMATE, PENDING COMPLETION OF RUNWAY RECONSTRUCTION PROJECT (SAFE) SMALL AIRCRAFT EXCLUSIVELY

ITEM	EXISTING	FUTURE
SIXTEENTH SECTION-LINE	---	SAME
QUARTER SECTION-LINE	---	SAME
SECTION-LINE	---	SAME
AIRPORT PROPERTY-LINE	---	SAME
BUILDING RESTRICTION LINE	---	SAME
RUNWAY CENTERLINE	---	SAME
RW/TW OBJECT FREE AREA (ROFA/TOFA)	---	ROFA - TOFA
OBJECT FREE ZONE (OFZ)	---	OFZ
RUNWAY SAFETY AREA (RSA)	---	RSA
RUNWAY PROTECTION ZONE (RPZ)	---	---
TOUCH-DOWN ZONE ELEVATION (TDZE)	---	---
DITCH / DRAINAGE	---	---
WILDLIFE FENCE	---	---
BUILDINGS	---	---
BITUMINOUS SURFACE	---	---
BEACON	---	---
G.P.S. MONUMENT	---	---
AIRPORT REFERENCE POINT	---	---
EDGE OF PAVEMENT	---	---
STORM SEWER	---	---
CONTROL POINT	---	---
GEOTECHNICAL BORING LOCATION	---	---

LEGEND

PHASE 1 / PHASE 2 / PHASE 3

NOTES

- APPROXIMATE, PENDING COMPLETION OF RUNWAY RECONSTRUCTION PROJECT.
- SEE SHEET 3 FOR IMAGINARY SURFACE PENETRATIONS.
- SMALL AIRCRAFT EXCLUSIVELY.

AIRPORT DATA

SCALE: 1" = 100 FEET (FULL SIZE)

TOWNSHIP 18N., RANGE 20W. P.M.M.

1" = 80' E
20' = 3"

MAGNETIC NORTH

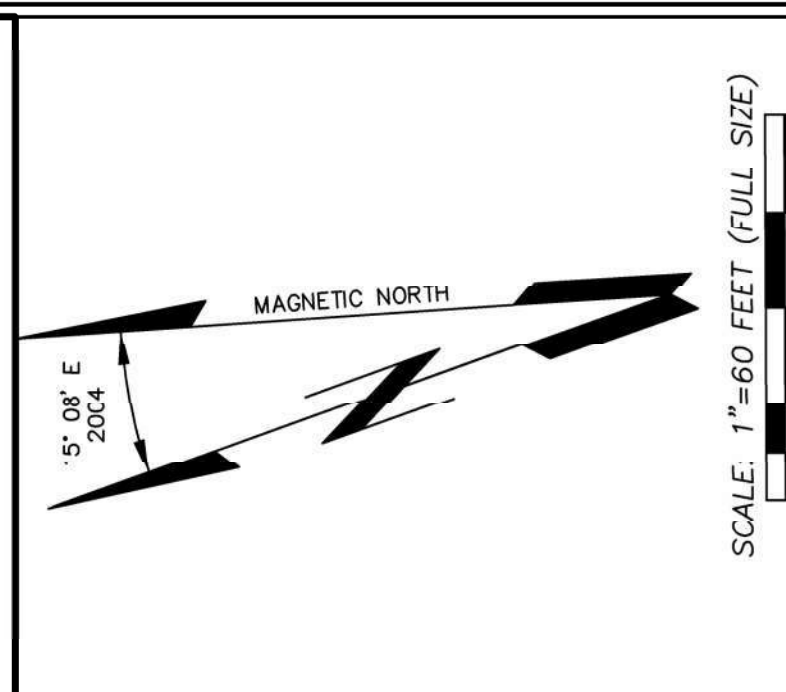
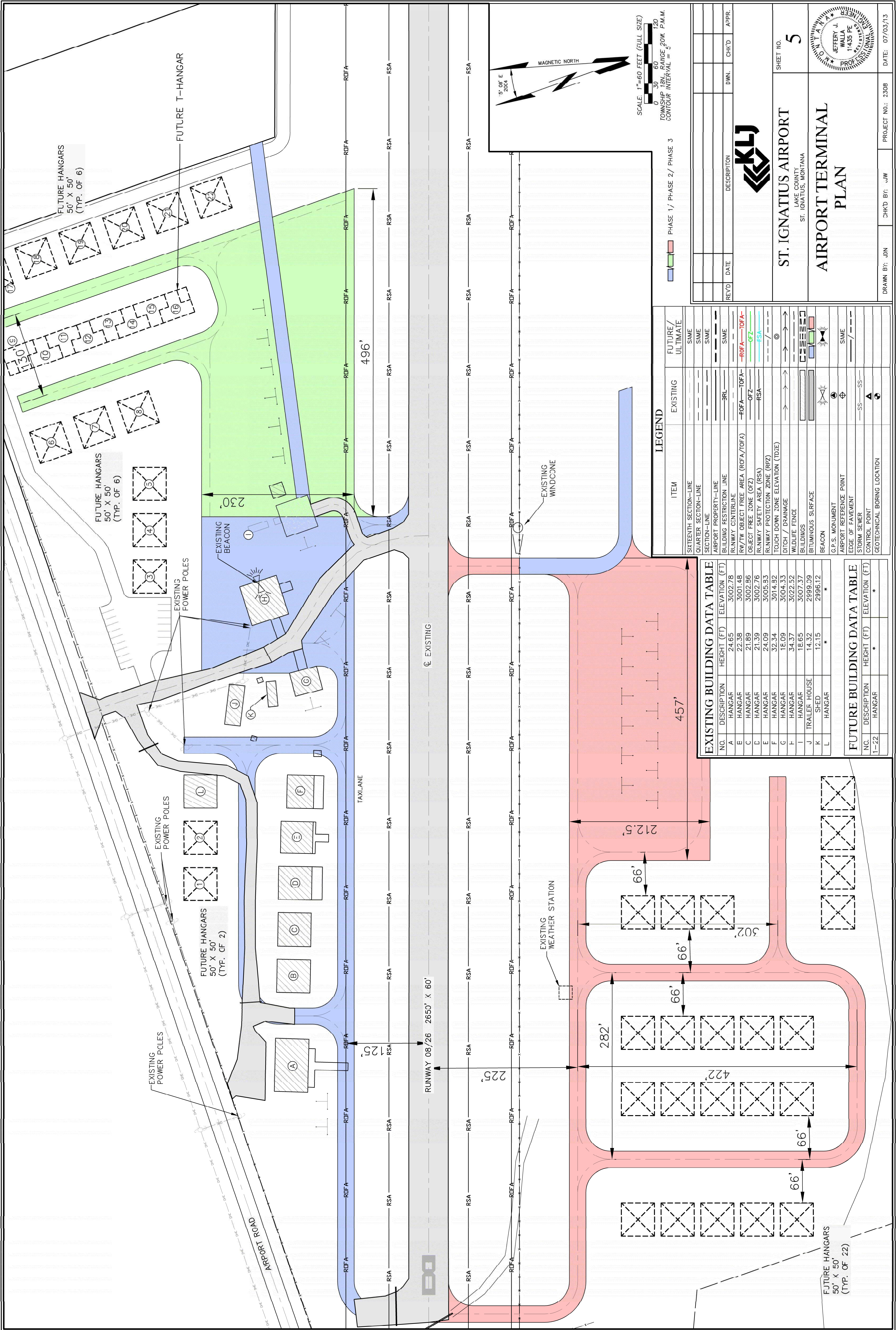

SCALE: 1"=60 FEET (FULL SIZE)
 TOWNSHIP 18N, RANGE 20W, P.M.M.
 CONTOUR INTERVAL = 5'

REV'D	DATE	DESCRIPTION	DWN.	CHK'D	A-PRR.



ST. IGNATIUS AIRPORT
 LAKE COUNTY
 ST. IGNATIUS, MONTANA

AIRPORT TERMINAL PLAN

SHEET NO. **5**

DATE: 07/03/13

PROJECT NO.: 2308

CHKD BY: JMW

DRAWN BY: JDN

ITEM	EXISTING	FUTURE/ULTIMATE
SIXTEENTH SECTION-LINE	---	SAME
QUARTER SECTION-LINE	---	SAME
SECTION-LINE	---	SAME
AIRPORT PROPERTY-LINE	---	SAME
BUILDING RESTRICTION LINE	---	SAME
RUNWAY CENTERLINE	---	SAME
RW/TW OBJECT FREE AREA (ROFA/TOFA)	---	ROFA-TOFA
OBJECT FREE ZONE (OFZ)	---	OFZ
RUNWAY SAFETY AREA (RSA)	---	RSA
RUNWAY PROTECTION ZONE (RPZ)	---	---
TOUCH DOWN ZONE ELEVATION (TDZE)	---	---
DITCH / DRAINAGE	---	---
WILDLIFE FENCE	---	---
BUILDINGS	---	---
BITUMINOUS SURFACE	---	---
BEACON	---	---
G.P.S. MONUMENT	---	---
AIRPORT REFERENCE POINT	---	---
EDGE OF PAVEMENT	---	---
STORM SEWER	---	---
CONTROL POINT	---	---
GEO/TECHNICAL BORING LOCATION	---	---

NO.	DESCRIPTION	HEIGHT (FT)	ELEVATION (FT)
A	HANGAR	24.65	3002.78
E	HANGAR	22.36	3001.48
C	HANGAR	21.89	3002.96
D	HANGAR	21.39	3002.76
E	HANGAR	24.09	3005.53
F	HANGAR	32.34	3014.92
G	HANGAR	18.09	3004.33
H	HANGAR	34.37	3022.52
I	HANGAR	18.65	3007.37
J	TRAILER HOUSE	14.32	2999.09
K	SHED	12.15	2996.12
L	HANGAR	*	*

NO.	DESCRIPTION	HEIGHT (FT)	ELEVATION (FT)
1-22	HANGAR	*	*