

**RUNWAY 18-36 PLAN**  
SCALE: 1"=1000' (FULL SIZE)

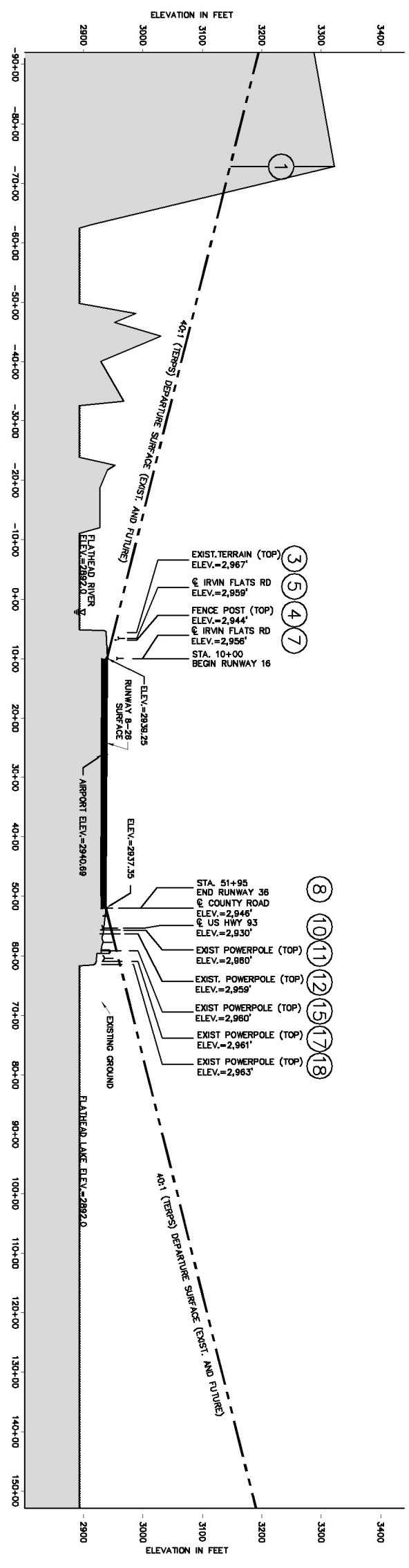

**RUNWAY 18-36 PROFILE**  
1"=1000' HORIZONTAL (FULL SIZE)  
1"=100' VERTICAL (FULL SIZE)

**OBSTRUCTION TABLE FOR PENETRATIONS TO RUNWAY 18-36 DEPARTURE SURFACE**

OBSTRUCTION I.D. NO.	DESCRIPTION	PENETRATION	DISPOSITION
1	TERRAIN	0' TO 175'	NONE
3	TERRAIN	0' TO 19'	NONE
4	FENCE POST	8'	NONE
5	IRVIN FLATS ROAD (INCL. 10' PENALTY)	20'	NONE
7	IRVIN FLATS ROAD (INCL. 10' PENALTY)	27'	NONE
8	COUNTY ROAD (INCL. 10' PENALTY)	11'	NONE
10	US HWY 93 (INCL. 15' PENALTY)	1'	NONE
11	POWERPOLE	13'	NONE
12	POWERPOLE	11'	NONE
15	POWERPOLE	8'	NONE
17	POWERPOLE	1'	NONE
18	POWERPOLE	3'	NONE

NOTES:  
1. 40:1 DEPARTURE SURFACE PENETRATIONS ARE SHOWN IN THE TABLE ABOVE.  
2. SEE SHEETS 5A & 5B FOR CLOSE-IN OBSTRUCTIONS TO THE DEPARTURE AND OTHER SURFACES.

REV'D	DATE	DESCRIPTION	DRAWN	CHECK'D	APPR.

**KLJ**

**POLSON AIRPORT**  
LAKE COUNTY JUNT. AIRPORT BOARD  
POLSON, MONTANA

**DEPARTURE SURFACE DRAWING (RUNWAY 18-36)**

SHEET NO. **6**

FILE NO.: 005-06  
DRAWN BY: NCV  
CHK'D BY: JMW  
PROJECT NO.: 0081-005  
DATE: 09/18/2016